

MUNDAY'S

Shenley Road, Camberwell

£1,650,000



Large, light and lovely enhanced and extended bay-fronted Victorian house with five bedrooms (all are doubles), two bathrooms, and a 'city' garden which faces east.

The handsome home is located on high ground on a quiet and tree-lined 'Lyndhurst toast-rack' street in Camberwell/Peckham Rye borderland. You are set between Denmark Hill and Peckham Rye Zone 2 stations; walk to these in 11 and 12 minutes respectively. Permit-parking is available on-street.

Munday's Estate Agents Ltd.
2 Mary Boast Walk
London SE5 8SP
020 3318 8900

www.mundays.com

MUNDAY'S



Munday's Estate Agents Ltd.
2 Mary Boast Walk
London SE5 8SP
020 3318 8900

www.mundays.com

Shenley Road

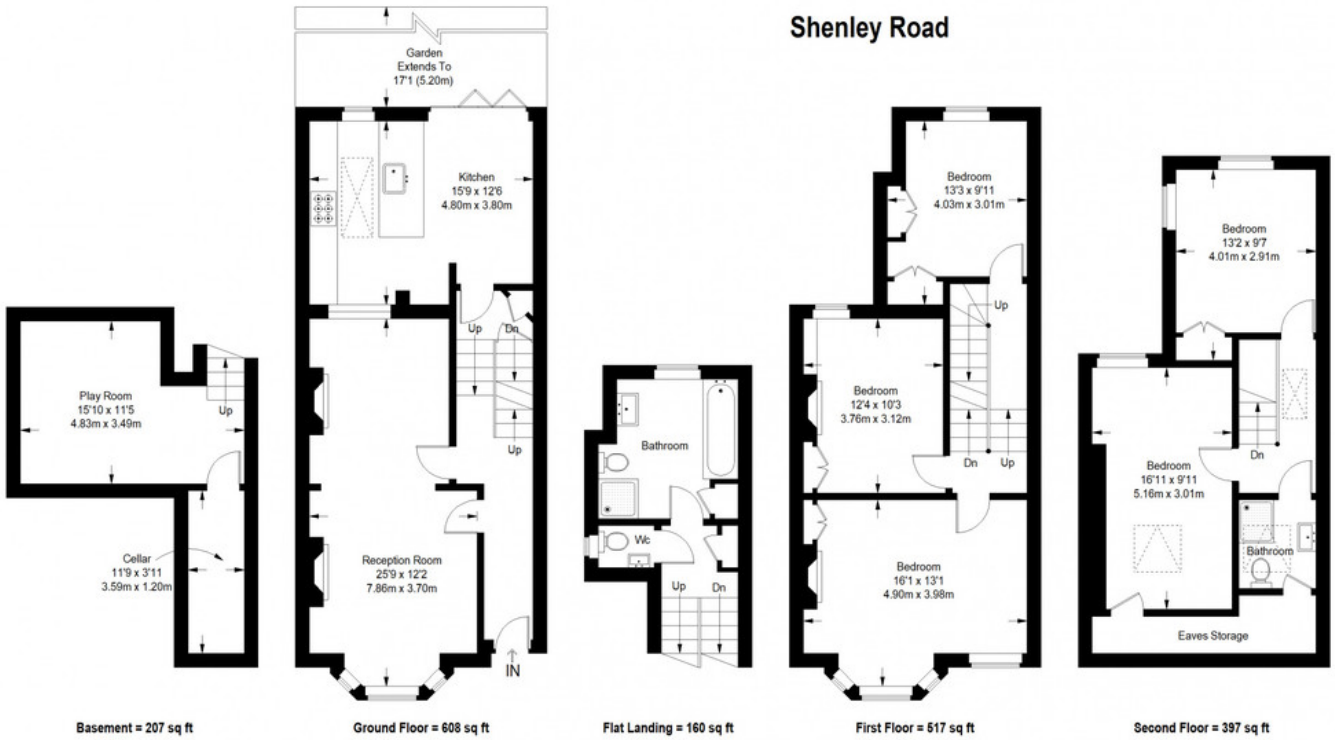

Approximate Gross Internal Area
 BASEMENT = 207 sq ft / 19.23 sq m
 GROUND FLOOR = 608 sq ft / 56.48 sq m
 FLAT LANDING = 160 sq ft / 14.86 sq m
 FIRST FLOOR = 517 sq ft / 48.03 sq m
 SECOND FLOOR = 397 sq ft / 36.88 sq m
 Total = 1889 sq ft / 175.49 sq m



This plan is for layout guidance only. Not drawn to scale unless stated. Windows and door openings are approximate. Whilst every care is taken in the preparation of this plan, please check all dimensions, shapes and compass bearings before making any decisions reliant upon them. (ID357409)