

Denmark Hill Estate, Camberwell

£495,000



Well these don't come along very often! A three bedroom ground-floor ex-LA apartment with a private garden, just an eight minute walk from Denmark Hill Station, and over the road from Ruskin Park. The icing on the cake is its chain-free status.

Find the pleasing apartment on the ground floor of a low-rise block. It is big at 804 square feet, and boasts a strong layout with a good 'flow' and with lots of inbuilt storage.

MUNDAY'S



Munday's Estate Agents Ltd.
2 Mary Boast Walk
London SE5 8SP
020 3318 8900

www.mundays.com

Cross Court

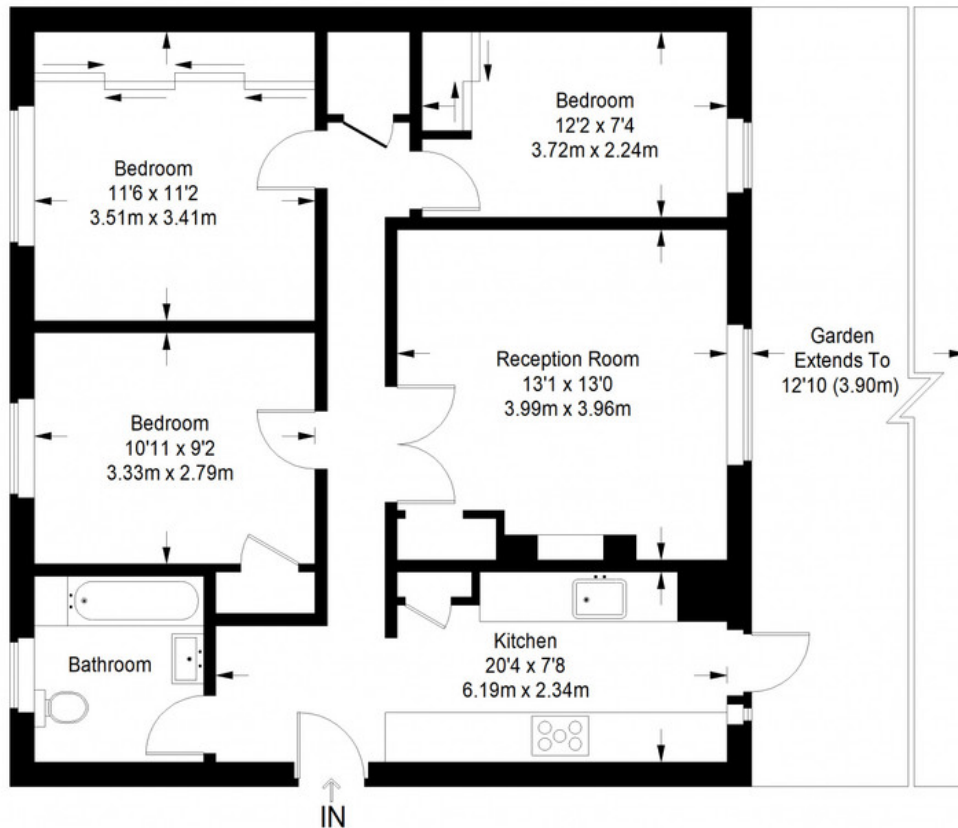

Ground Floor = 804 sq ft

Approximate Gross Internal Area
GROUND FLOOR = 804 sq ft / 74.69 sq m
Total = 804 sq ft / 74.69 sq m



This plan is for layout guidance only. Not drawn to scale unless stated. Windows and door openings are approximate. Whilst every care is taken in the preparation of this plan, please check all dimensions, shapes and compass bearings before making any decisions reliant upon them. (ID357409)