

Denman Road, Peckham Rye

£799,950



Beautiful architecturally-treated two double bedroom garden flat of over 800 square feet, with a Freehold-share. The handsome property is the extended ground floor of a smart Victorian house.

Your mature east-facing private garden is accessed via the large rear room (it runs over 40 feet and is framed by other gardens; giving you lovely leafy vistas from all angles).

Find it one of the prettiest residential Peckham Rye streets (it is one of the 'Lyndhurst toast-rack' ones, close to Peckham Rye Station: walk eight minutes, and just six to Bellenden Road). There is permit-parking on-street.

MUNDAY'S



Munday's Estate Agents Ltd.
2 Mary Boast Walk
London SE5 8SP
020 3318 8900

www.mundays.com

Denman Road

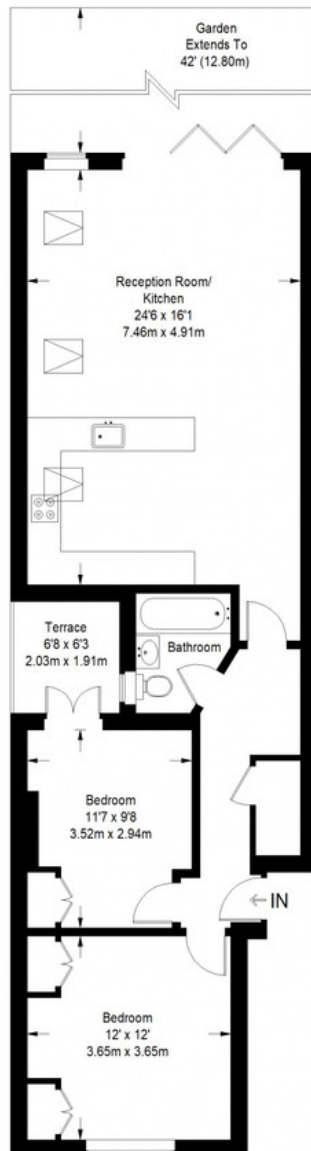

Ground Floor = 813 sq ft

Approximate Gross Internal Area
GROUND FLOOR = 813 sq ft / 75.53 sq m
Total = 813 sq ft / 75.53 sq m



This plan is for layout guidance only. Not drawn to scale unless stated. Windows and door openings are approximate. Whilst every care is taken in the preparation of this plan, please check all dimensions, shapes and compass bearings before making any decisions reliant upon them. (ID357409)