

MUNDAY'S

Hollydale Road, Peckham

£695,000



Viewings available Saturday 11th May and Saturday 18th May.

Architecturally-treated two bedroom Victorian conversion apartment with a mature and low-maintenance south-west facing garden (hi, sunshine!) of over 40 feet.

A fab flat and a swell location, too — you are just a seven minute walk from both Queens Road and Nunhead Stations (both Fare Zone 2).

*Munday's Estate Agents Ltd.*  
2 Mary Boast Walk  
London SE5 8SP  
020 3318 8900

[www.mundays.com](http://www.mundays.com)

MUNDAY'S



*Munday's Estate Agents Ltd.*  
2 Mary Boast Walk  
London SE5 8SP  
020 3318 8900

[www.mundays.com](http://www.mundays.com)

# MUNDAY'S

## Hollydale Road

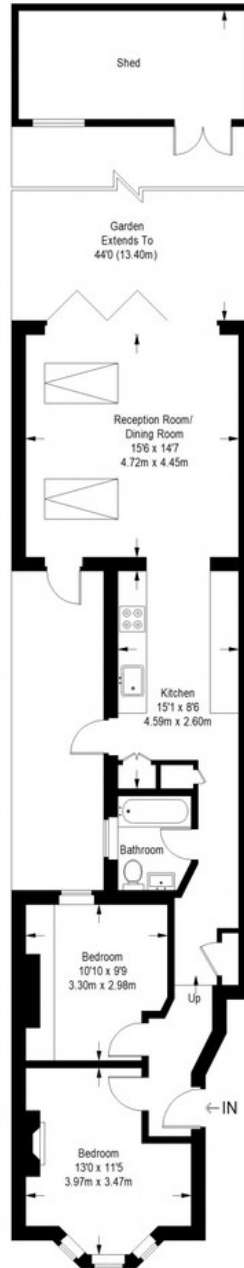

**Ground Floor = 734 sq ft**

Approximate Gross Internal Area  
GROUND FLOOR = 734 sq ft / 68.19 sq m  
Total = 734 sq ft / 68.19 sq m



This plan is for layout guidance only. Not drawn to scale unless stated. Windows and door openings are approximate. Whilst every care is taken in the preparation of this plan, please check all dimensions, shapes and compass bearings before making any decisions reliant upon them. (ID357409)

*Munday's Estate Agents Ltd.*  
2 Mary Boast Walk  
London SE5 8SP  
020 3318 8900

[www.mundays.com](http://www.mundays.com)